

RAIDON

GR5630-SB3+ 快速安裝導引

產品示意圖與配件表

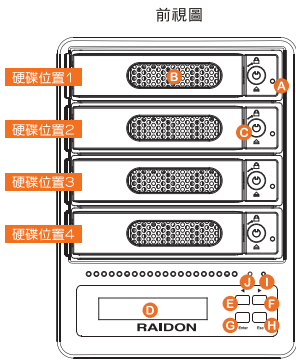

- A 硬碟狀態顯示燈
- B 硬碟抽取盒
- C 硬碟卡榫按鍵
- D LCM顯示幕
- E UP按鍵
- F DOWN按鍵
- G ENTER按鍵
- H ESC按鍵
- I 電源指示燈
- J 系統警示燈

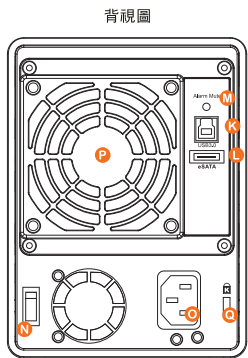

- K USB3.0連接埠
- L eSATA連接埠
- M 靜音按鈕
- N 電源開關
- O 電源插座
- P 風扇
- Q 防竊鎖孔

本產品是採用低噪音的電源供應器，當通電時的負載未達50%，電源供應器的風扇會暫停轉動。

V1.1 (Jul. 2017)

1

打開包裝外盒後，包裝內容應包含下列組件：

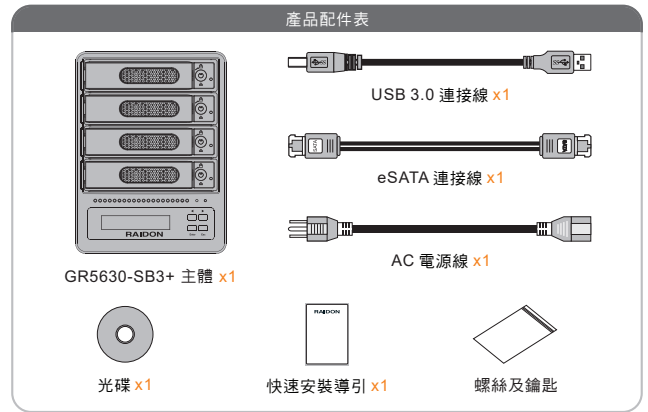

請先確認相關配件與產品本身是否有受損或是缺少配件，若有任何疑問，請與您的經銷商或業務人員聯絡。

硬碟托盤燈號與蜂鳴器顯示的各種訊息

狀態	前置 LED			蜂鳴器
	電源指示燈	系統警示燈	硬碟狀態顯示燈	
開機	藍燈恆亮	---	藍燈閃爍→恆亮	啟動完成時 1 長音
無硬碟	藍燈恆亮	---	---	---
硬碟故障	藍燈恆亮	---	紅燈恆亮	---
RAID 毀損	藍燈恆亮	---	紅燈恆亮	4 短音
閒置	藍燈恆亮	---	藍燈恆亮	---
格式化	藍燈恆亮	---	藍燈閃爍	---
資料存取	藍燈恆亮	---	藍燈閃爍	---
資料重建 - 來源碟	藍燈恆亮	---	藍燈閃爍	---
資料重建 - 資料碟	藍燈恆亮	---	藍紫燈交互閃爍	---
風扇故障	藍燈恆亮	紅燈	藍燈恆亮	4 短音
過熱	藍燈恆亮	紅燈	藍燈恆亮	4 短音

2

硬碟安裝

步驟2 將系統擺放在穩固平台，並確認散熱風扇口沒有被其它物體擋住，系統四周有適當的散熱空間。(擺放環境請避免接近潮濕或其它亦對產品造成損傷的環境)

步驟3 請使用零件包內附的鑰匙插入鑰匙孔向左轉90度，輕按鎖頭抽取盒門門將會輕彈開啟，即可將硬碟抽取盒取出。

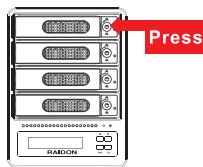

步驟4 將硬碟安裝到抽取盒上，並以零件包內附的螺絲加以固定，以避免不必要的移動對硬碟造成傷害。

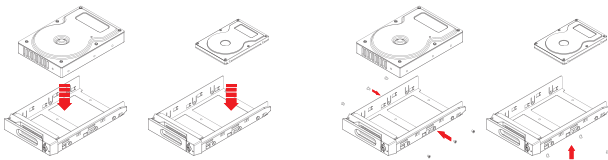

步驟5 硬碟安裝完成後，請將抽取盒平移放入主機內，並關上把手。

步驟6 將AC Power電源線與GR5630-SB3+連接，再將AC Power電源線與電源插座連接，執行開機。

步驟7 透過前方的LCD與按鍵來設定您所需求的儲存模式。(請參考"前面板操作及LCD訊息說明")

步驟8 將附件中的連接線分別接到PC與GR5630-SB3+的相關連接埠。

步驟9 開機後，您的作業系統將會自動辨識到RAID容量；待辨識成功後，請依據您所需的儲存格式，將系統內的硬碟依照作業系統的指示完成格式化。待格式化完成後，便可直接執行RAID系統。

前面板操作

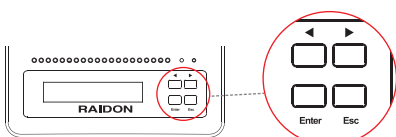

Enter: 進入下一層 或是 確認
Esc: 跳回上一層 或是 取消
Up / Down: 循序選擇項目

使用者可經由面板進行 RAID操作，GR5630-SB3+ 預設值為 JBOD，可進入 Quick Setup快速設定成 RAID 0 或是 RAID 5 模式使用。

如需進行其他設定，則可參考下列 LCD 說明進行操作。

3

LCD 訊息說明

Level 0	Level 1	Level 2	Level 3	Level 4	
External 4BAY HARDWARE RAID	Quick Setup	Create One RAID	RAID 0/ RAID 5	Select Disk	
		Delete All RAID			
	Disk Manager	Identify Disk	Disk 1	Check Disk LED	
			Disk 2	Check Disk LED	
			Disk 3	Check Disk LED	
			Disk 4	Check Disk LED	
	RAID Manager	Show Disk Info	< Disk Info >		
		Identify RAID	Select RAID		
		Create RAID	RAID 0 / RAID 5	Select Disk	
		Delete RAID	Select RAID		
		RAID Info			
		Change RAID Pwd	< Password > for RAID Setup		
Rebuilding Priority		Highest/High/Medium/Low/Lowest			
Standby Timer		< 99999min >			
System Info		Firmware Version			
Change Password		< Password > for System Info			
System Manager	Logout From Menu	< Y or N >			
	Alarm Control	Mute the Buzzer			
	Hardware Monitor	Voltage Monitor	< 3.3V/5V/12V >		
		Temp. Monitor	< Temp. >		
Fan Monitor		< Fan Speed / Fan Level >			

感謝您使用 銳銳科技股份有限公司 的產品。

本手冊裡的資訊在出版前雖然已經被詳細確認，但實際產品規格將以出貨時為準；任何的產品規格或相關資訊更新，請您直接上www.RAIDON.com.tw網站查詢，或是直接與您的業務聯絡窗口聯繫，本公司將不另行通知。

如果您對 銳銳科技 的產品有任何疑問，或是想獲得最新產品訊息、使用手冊或軟體，請您聯絡 supporting@raidon.com.tw，我們將儘速回覆您。

說明相關產品內容歸 銳銳科技股份有限公司 版權所有

4

RAIDON

GR5630-SB3+ Quick Installation Guide

Product Diagrams and Contents of Product Package

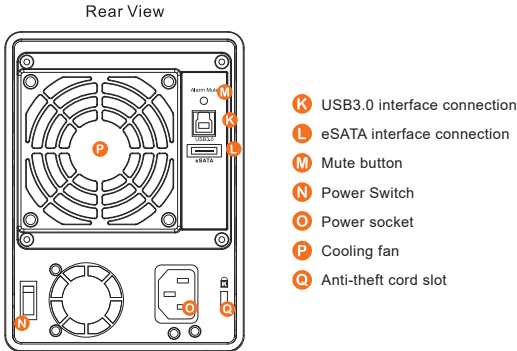
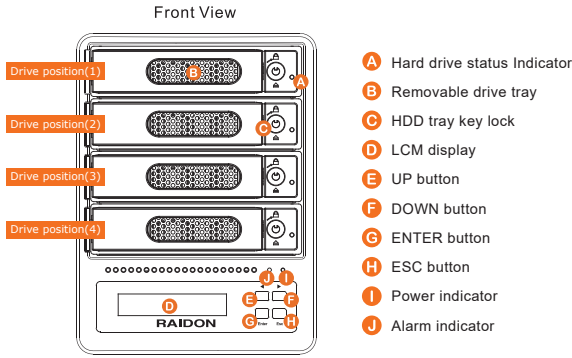

This products uses a low-noise Switching Power Supply. Its built-in fan will temporary stop while the total power consumption is below 50% of the full load.

V1.1 (Jul. 2017)

1

After you open the outer package, make sure that the following items are contained in the package:

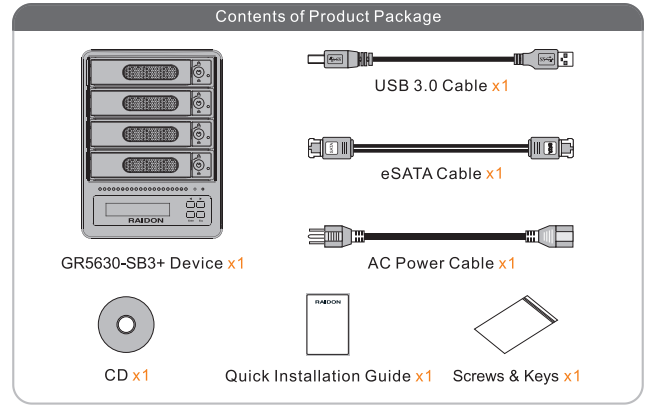

Please check and make sure the product unit and all its accessories are without any physical damage or missing parts.

Message Indication of LED and Buzzer

Constant	Front LED			Buzzer
	Power LED	Larm LED	HDD LED	
Power ON	Blue	---	Blue Flashing → Blue	1 long when booting finished
No HDD	Blue	---	---	---
Disk Failed	Blue	---	Red	---
RAID Failed	Blue	---	Red	4 Short
Disk Idle	Blue	---	Blue	---
Format	Blue	---	Blue Flashing	---
Access	Blue	---	Blue Flashing	---
Rebuilding - Source	Blue	---	Blue Flashing	---
Rebuilding - Target	Blue	---	Blue and Purple Flashing	---
Fan Failed	Blue	Red	Blue	4 Short
Over Temp	Blue	Red	Blue	4 Short

2

Hardware Installation

- Step 1 Open the package and take out the product making sure that all the enclosed contents are not damaged or missing. Should you find damages or missing contents, please contact your supplier immediately.
- Step 2 Place the system on a stable surface. Ensure that it is well ventilated without blockage to the vent and kept away from areas near water and damage prone areas.
- Step 3 Use the key included in the accessory kit and inserted into the key access opening to eject the removable drive tray latch and extract the removable drive tray.

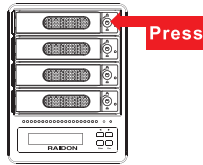

- Step 4 Mount your hard drives onto the removable drive tray and secure it with the screws included in the accessory kit to avoid any damage to the hard drive due to accidental movements.

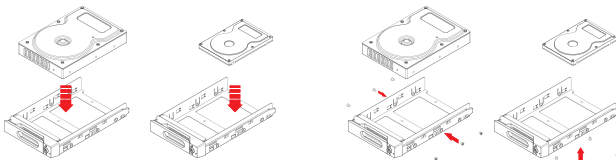

- Step 5 When the hard drive installation has been completed, insert the hard drive tray into the system horizontally and secure the latch into place.
- Step 6 Connect the AC power cable to the GR5630-SB3+, and then plug the AC power to the wall socket. Boot-up the unit.
- Step 7 Set the storage mode using the LCD and buttons on the front (please refer to section 5 for front panel and LCD information).
- Step 8 Connect the cable to the PC and the GR5630-SB3+ port.
- Step 9 After boot-up, your operating system will automatically detect the storage capacity of your hard drives. Please follow the operating system instructions to configure and format your drives. The formatted drives can be configured for the RAID setup.

3

Description of Front Panel Operation

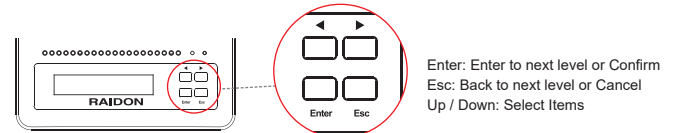

Users can set the RAID mode using the LCD and buttons on the front. The default is JBOD mode. Using "Quick Setup" function, users can change the RAID mode to RAID 0 or RAID 5 quickly.

Please refer to LCD Information as below for other setting.

LCD Information

	Level 0	Level 1	Level 2	Level 3	Level 4	
External 4BAY HARDWARE RAID		Quick Setup	Create One RAID Delete All RAID	RAID 0/ RAID 5	Select Disk	
		Disk Manager	Identify Disk	Disk 1	Check Disk LED	
				Disk 2	Check Disk LED	
				Disk 3	Check Disk LED	
				Disk 4	Check Disk LED	
		RAID Manager	Show Disk Info	< Disk Info >		
			Identify RAID	Select RAID		
			Create RAID	RAID 0 / RAID 5	Select Disk	
			Delete RAID	Select RAID		
			RAID Info			
			Change RAID Pwd	< Password > for RAID Setup		
		System Manager	Rebuilding Priority	Highest/High/Medium/Low/Lowest		
			Standby Timer	< 99999min >		
			System Info	Firmware Version		
			Change Password	< Password > for System Info		
	Logout From Menu		< Y or N >			
	Hardware Monitor	Alarm Control	Mute the Buzzer			
		Voltage Monitor	< 3.3V/5V/12V >			
			Temp. Monitor	< Temp. >		
		Fan Monitor	< Fan Speed / Fan Level >			

RAIDON reserve the right to revise all the information in this manual without further notice

Copyright © RAIDON TECHNOLOGY, INC. All rights reserved.

4